

## Appendix A

### What can be learnt from the Housing Question in the Neighbourhood Plan's Residents' Questionnaire?

The question posed was: "*If new homes are to be built in the local area, which of the following do you think should be prioritised?*"

Analysing the responses in the light of the Housing Priorities already identified by the N P Housing Group we have:

<u>Housing Priorities</u>	<u>Observation</u>
1. Lack of suitable accommodation for the over 55s	<p>Amongst 60+ year olds, a high proportion list a 1 or 2 bed apartment with an on-site care facility.</p> <p>Huge increase amongst the over 60s in listing the need for social housing. Could be indicative amongst other things of people trapped in their council house and unable to move without there being a socially provided solution.</p>
2. Lack of reasonably priced accommodation for young and growing families.	<p>Clear perceived need for 2 or 3 bedroom houses, <b>not 4 bed ones</b>.</p> <p>Amongst 30+ year olds a jump occurs in the perceived need for shared ownership.</p> <p>Both could be indicative of the financial difficulty of moving out of a flat into one's first house.</p>
3. Difficulties experienced by many young persons in securing their first independent accommodation.	<p>Difficult to discern from the questionnaire responses. Though need for 1 bed flats is a substantial proportion of all flats.</p>
4. General lack of social housing	<p>Consistently identified across all Age Groups at a level such that <math>\frac{1}{3}</math> rd of all new build should be social rented housing.</p>

The question, as posed, did not involve any element of prioritising by respondents as to which housing types they considered to be the highest priority, nor did it require any indication of their reasoning. On average respondents selected  $\pm 5$  of the listed categories.

The response rates varied tremendously as between the different age groups.

<b>AGE GROUP</b>	<b><u>Popul</u> <u>Total</u></b>	<b><u>ation</u> <u>%</u></b>	<b><u>Respon</u> <u>Total</u></b>	<b><u>dents</u> <u>%</u></b>	<b><u>Response</u> <u>Rate - %</u></b>	<b><u>Accom Units /</u> <u>Respondent</u></b>
<b>19 – 29</b>	2,310	14.0	61	3.0	2.86%	5.87
<b>30 - 39</b>	3,428	20.7	331	16.1	9.66%	4.95
<b>40 - 49</b>	3,100	18.7	380	18.5	12.95%	4.52
<b>50 - 59</b>	2,771	16.8	356	17.3	12.13%	5.15
<b>60 - 69</b>	2,204	13.3	428	20.8	19.43%	5.29
<b>Over 70</b>	2,734	16.5	498	24.3	18.22%	4.26
<b>ALL</b>	16,547	100%	2,054	100%	12.55%	

Accordingly when producing summary All Respondents results, statistical corrections have been made as follows:

- within each Age Group the average number of housing types has been reduced to one per respondent, proportionately allocated
- each age group has been assigned the same weight as it had in the ONS January 2013 Census figures for Godalming (Census data + how it has been transformed, as ONS and GoFar Questionnaire age breaks do not correspond - see pages \*)

A set of charts show for each Age Group showing (1) their housing priority split between 1, 2, 3 & 4 bedroom flats and houses; and (2) their indicated priorities by ownership type, follow these notes.

There is a fair degree of consistency between the various Age Groups as to how each group perceives GoFar's housing priorities. In particular:

- the need for more Social Rented Housing overall rates a third of all new build housing ; somewhat lower among the younger 19 – 39 age groups, and above that average among the 50 – 70+ year olds.
- Shared Ownership rates a fifth of all new build housing, interestingly this rises significantly as people turn 30.

As regards housing type (unfortunately Shared Ownership did not distinguish between flats and houses), the greatest priorities are for 3 and 2 bedroom houses followed by 2 and 1 bedroom flats.

Need for housing with some form of care facility is surprisingly high at above 10% of all new build housing, with older groups perceiving the greatest need.



Unsurprisingly it is more associated with 1 or 2 bed properties, presumably single floor apartments rather than houses (though this split is not available from the questionnaire data). A quirk of the questionnaire in having grouped 4 bed and larger properties together, is that whilst overall need for 4 bed properties is low, it generates a huge uplift in need for a care facility – possibly indicative that people don't see care being delivered in a standalone properties.

**19 – 29 Years**

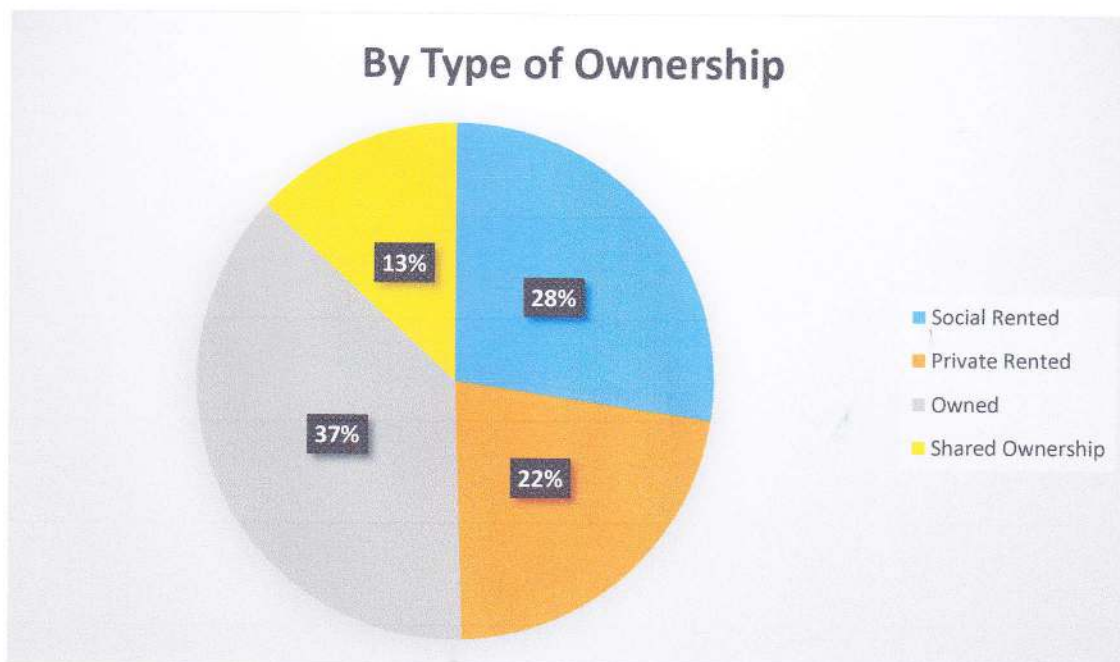
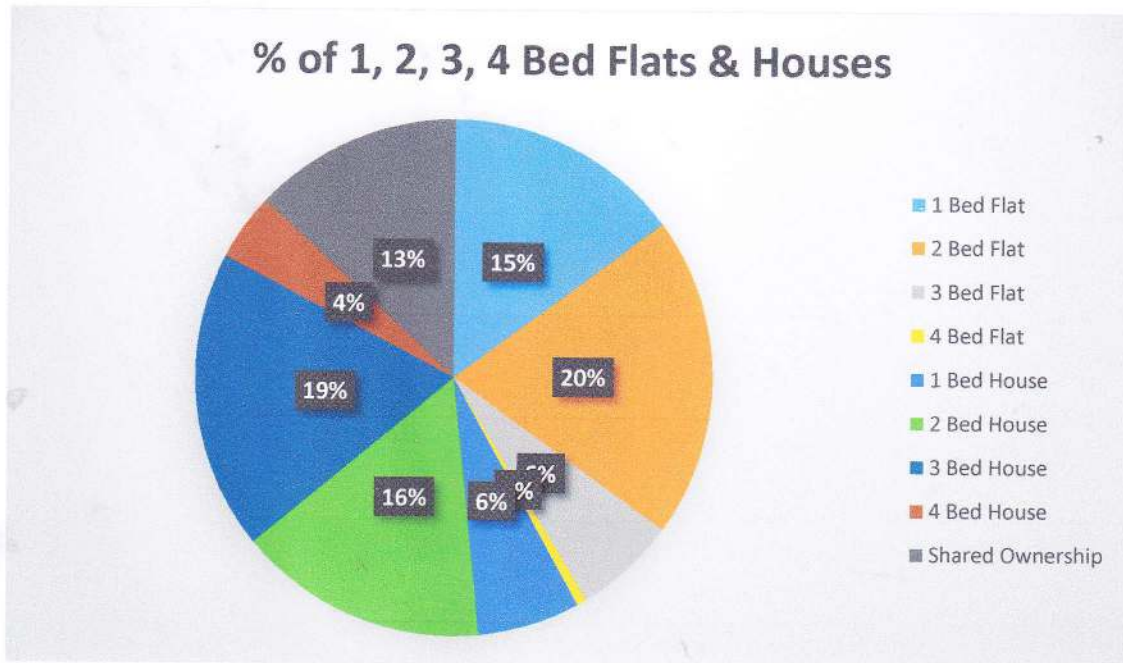

**30 – 39 Years**

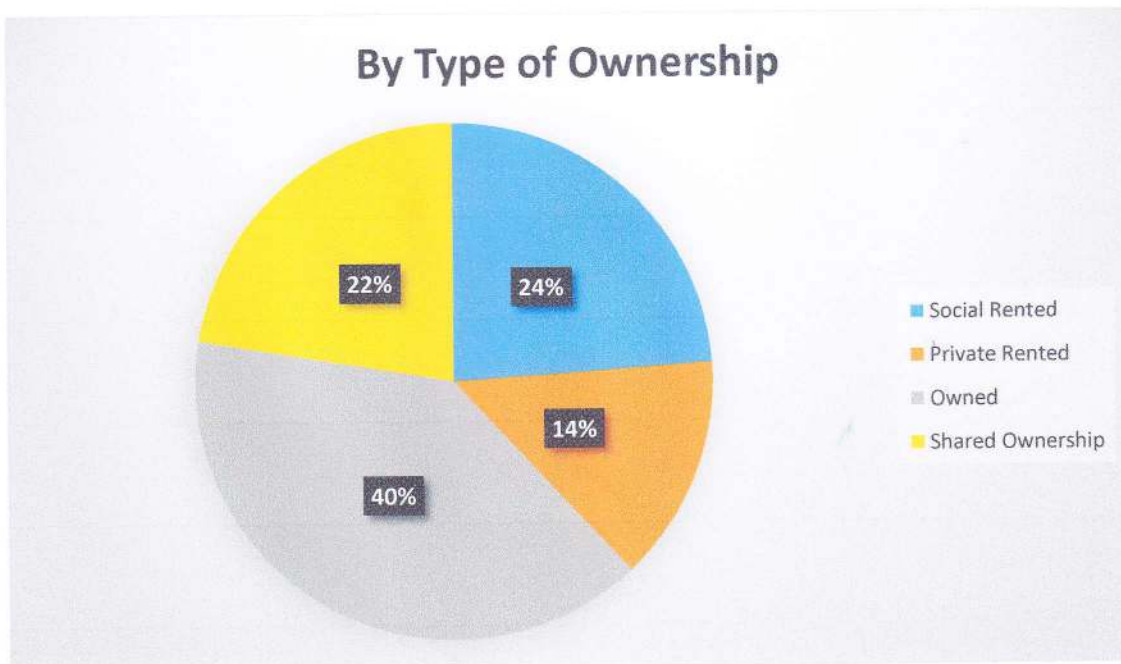
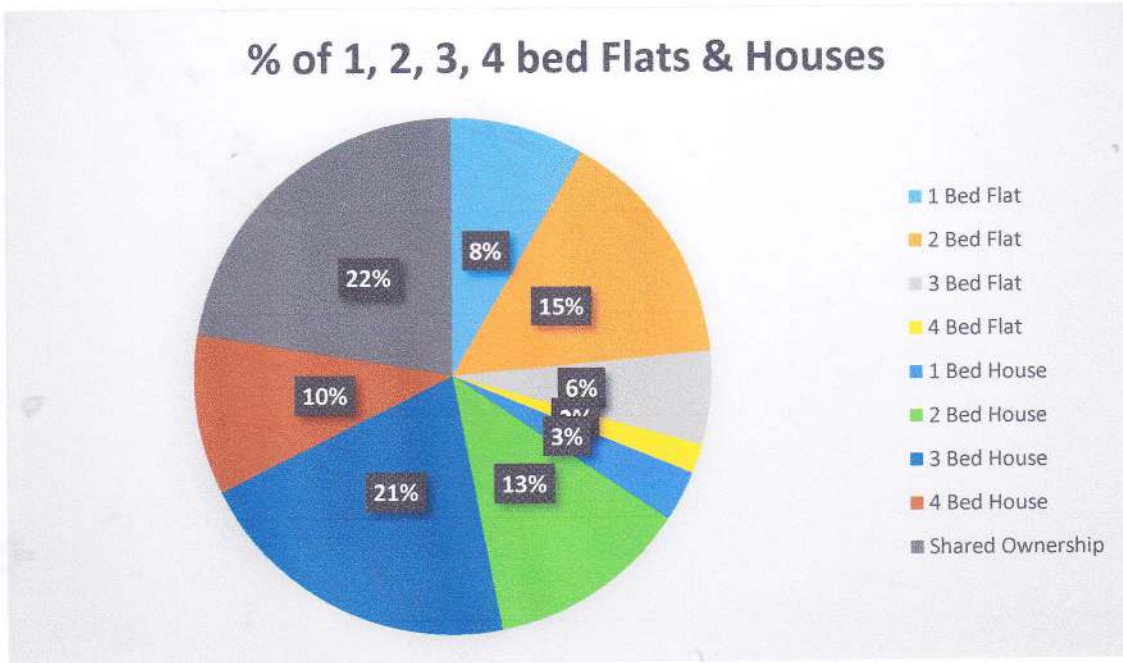

**40 – 49 Years**

**% of 1, 2, 3, 4 bed Flats & Houses**

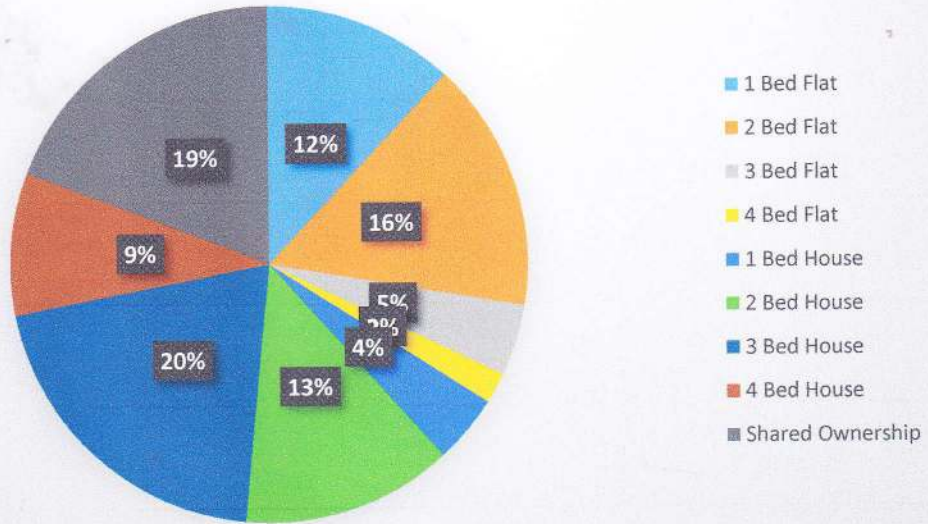

**By Type of Ownership**

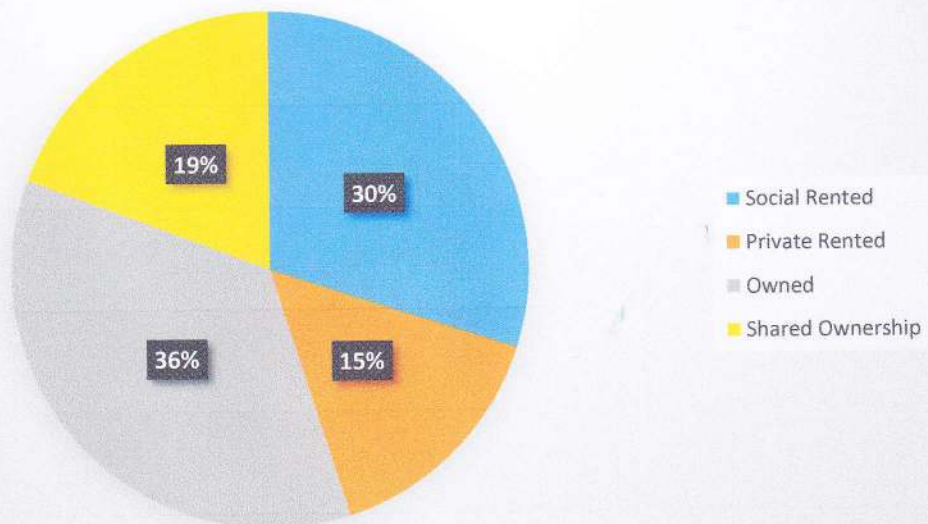

**50 – 59 Years**

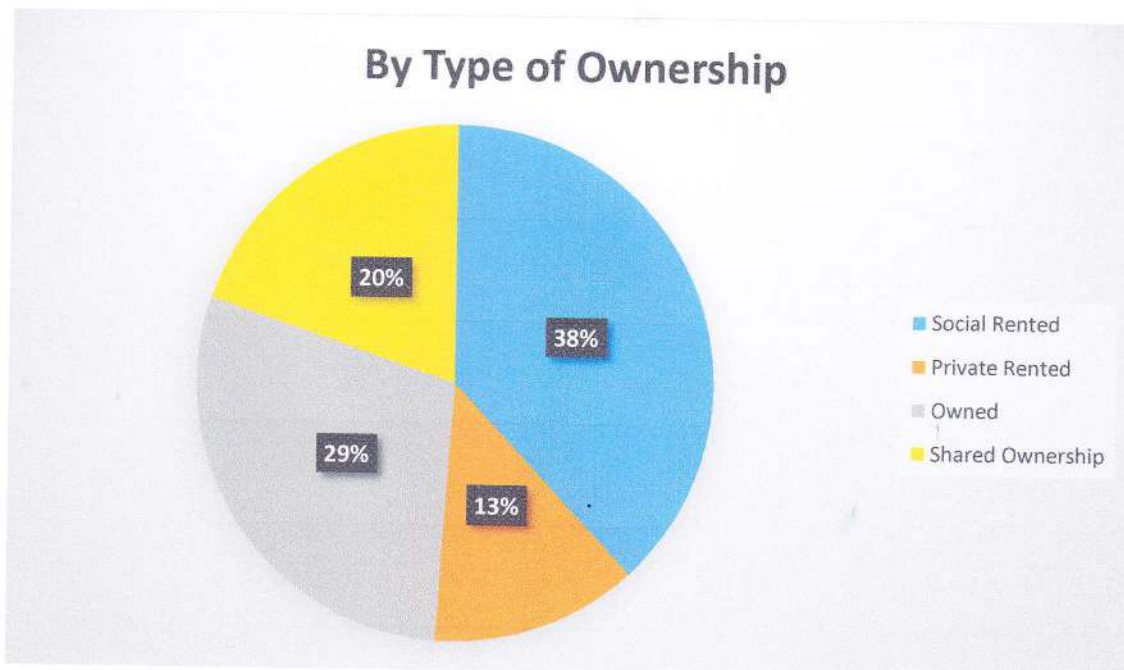
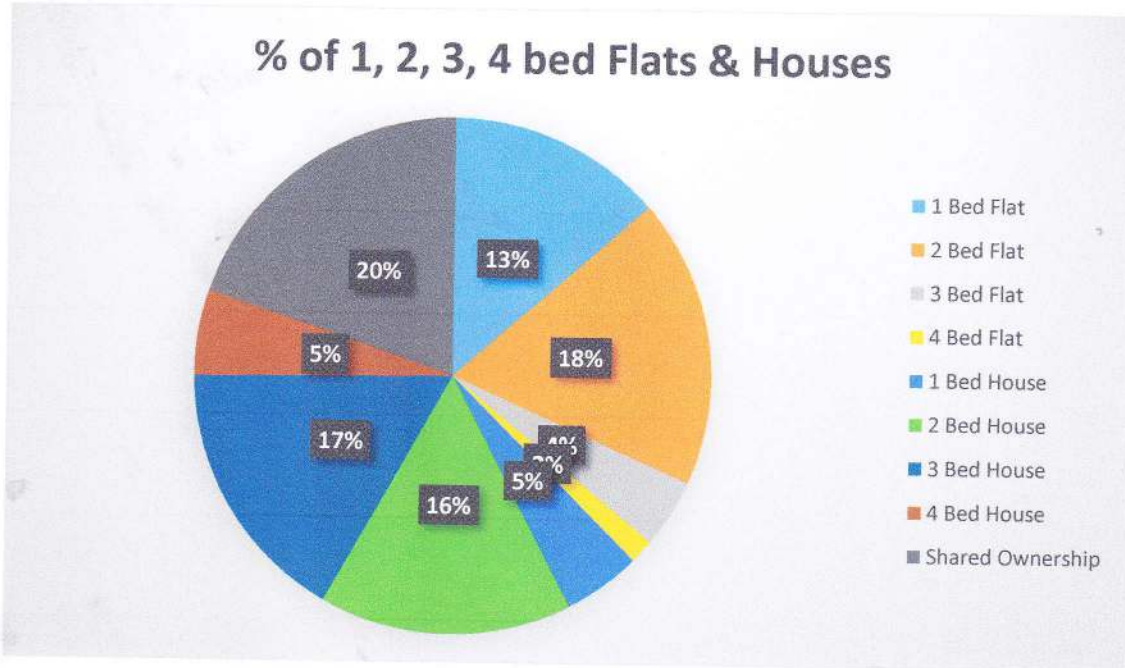

**60 – 69 Years**

**% of 1, 2, 3, 4 bed Flats & Houses**

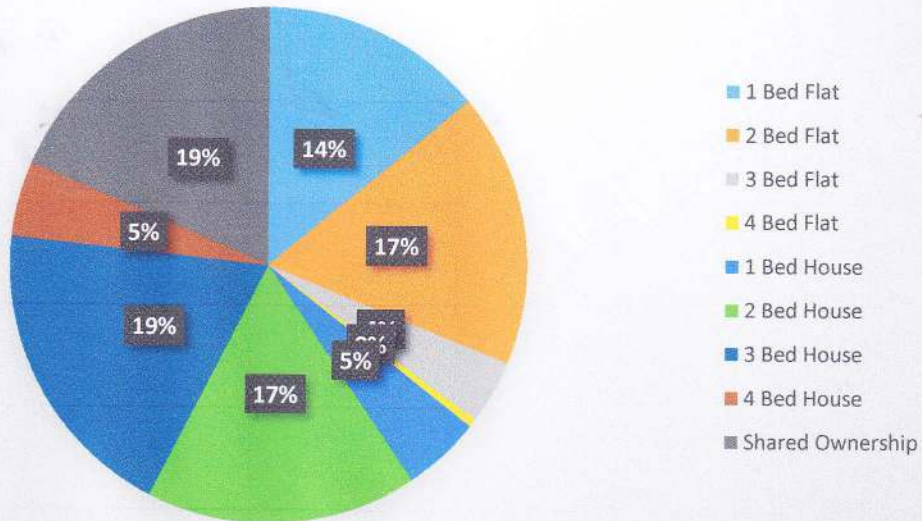

**By Type of Ownership**

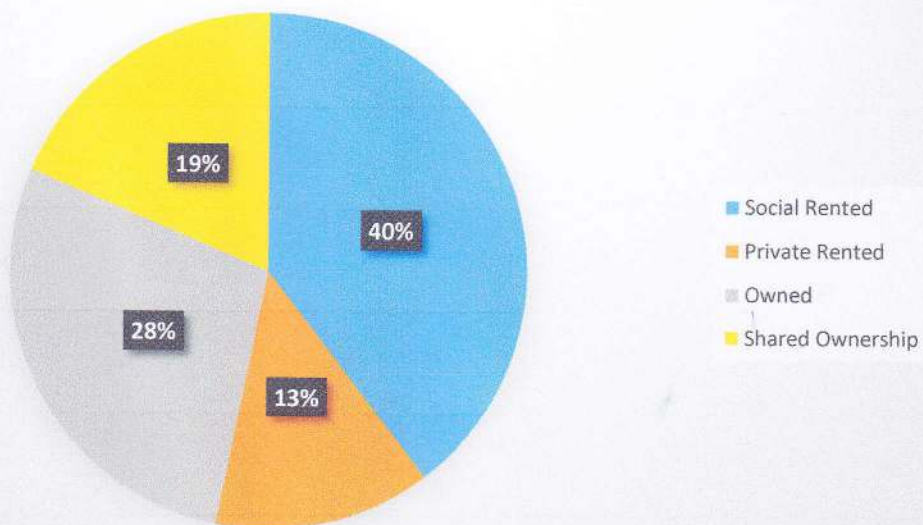



**Over 70 Years**

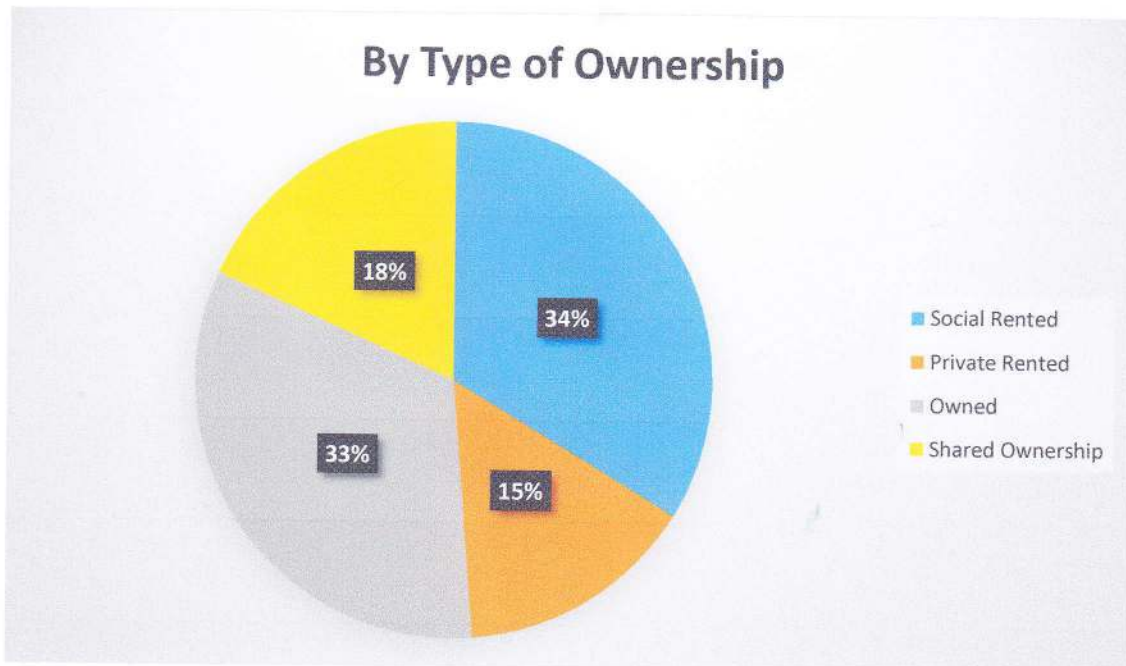
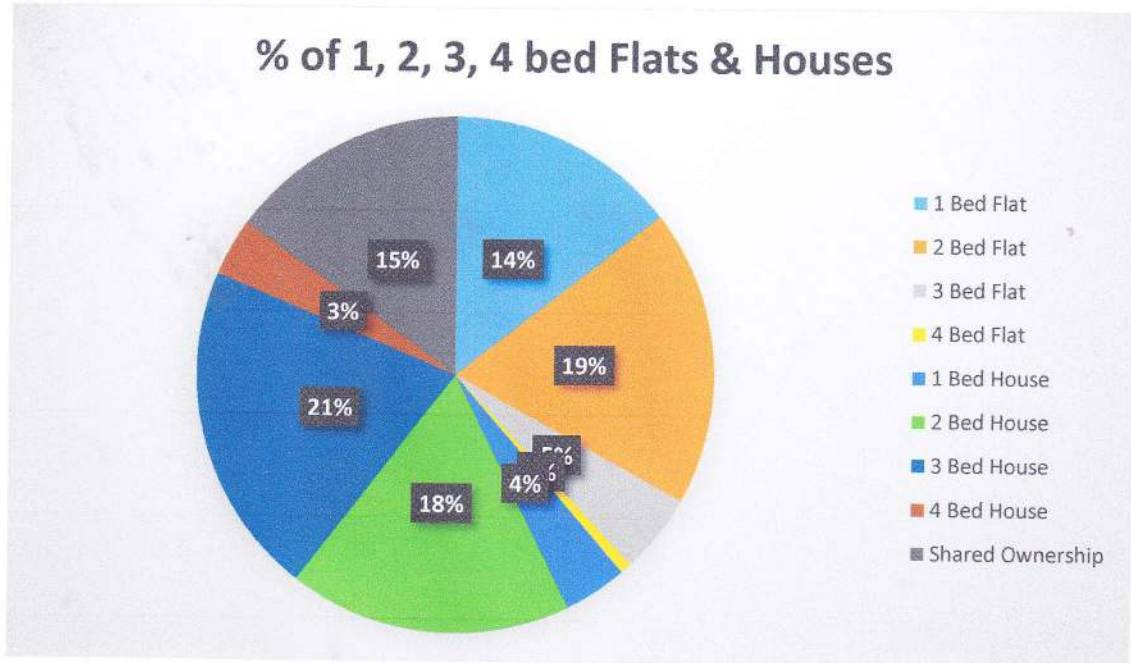

## All Groups based on ONS Population Proportions

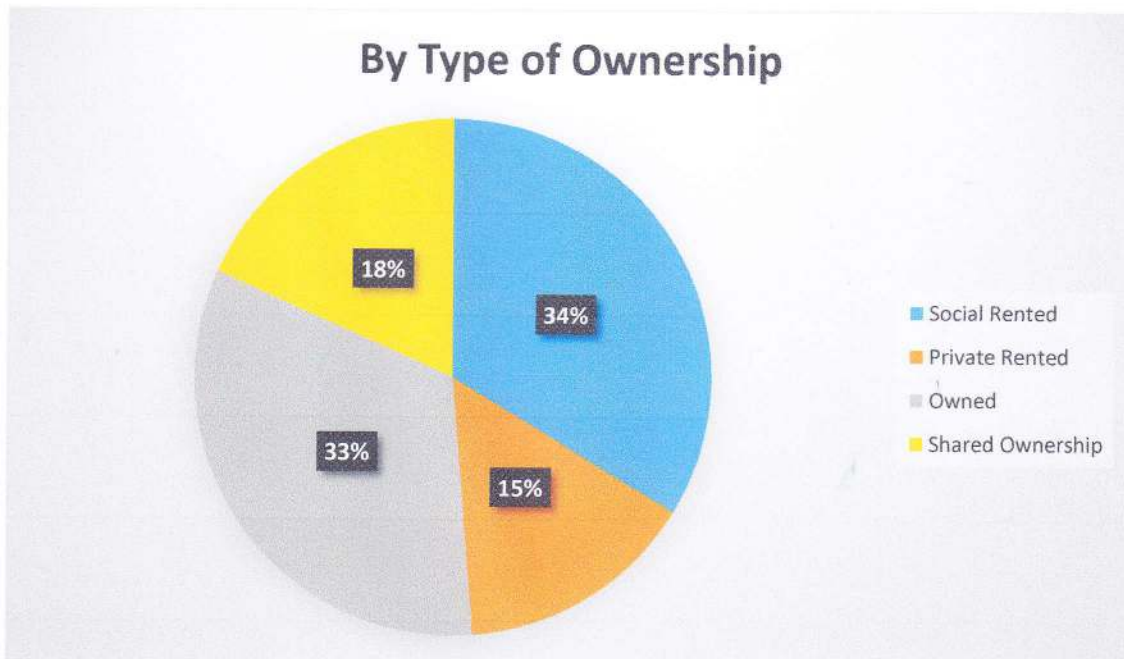
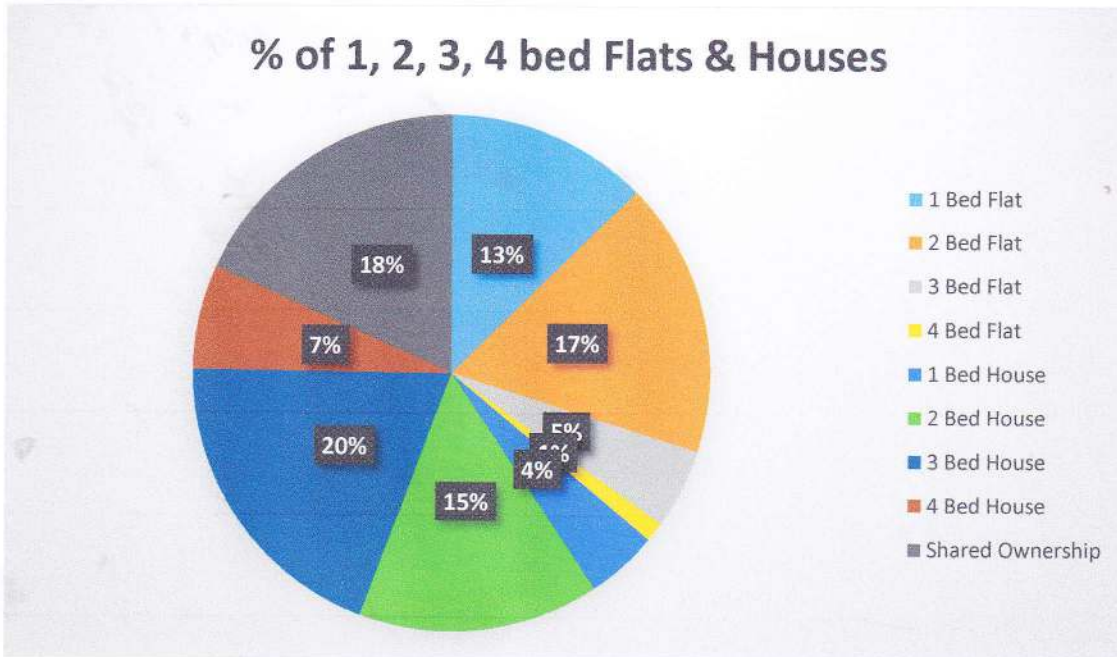

**ALL 19 - 70+ Yrs  
(2054 respondents)**

	Social Rented			Private Rented			Shared Ownership			Wholly Owned			GRAND TOTALS All Yrs			With a Care Facility %
	Flat	House	Combined	Flat	House	Combined	Flat	House	Combined	Flat	House	Combined	Flat	House	Combined	
1 - Bed	138	46	183	48	14	62	79	77	29	106	262	89	430	92	21.38%	
	6.71%	2.23%	8.93%	2.31%	0.69%	3.00%	3.83%	3.75%	1.41%	5.15%	12.77%	4.33%	20.92%	97	11.57%	
2 - Bed	160	155	315	74	48	121	168	120	116	235	353	319	840	86	10.33%	
	7.79%	7.55%	15.34%	3.59%	2.32%	5.91%	8.16%	5.82%	5.64%	11.46%	17.21%	15.51%	40.88%	30	5.01%	
3 - Bed	37	168	205	21	62	83	104	40	173	212	97	403	604	31	5.11%	
	1.79%	8.20%	9.99%	1.02%	3.00%	4.02%	5.04%	1.93%	8.40%	10.33%	4.74%	19.60%	29.39%	33	18.38%	
4 - Bed	10	32	42	3	18	21	30	10	77	87	24	127	181	33	18.38%	
	0.50%	1.56%	2.06%	0.17%	0.88%	1.05%	1.47%	0.50%	3.74%	4.2%	1.16%	6.18%	8.82%	253	12.32%	
Totals	345	401	746	146	141	287	380	246	394	641	737	937	2,054			
	16.79%	19.54%	36.33%	7.10%	6.89%	13.98%	18.50%	12.00%	19.19%	31.19%	35.88%	45.62%	100.00%			

NB based on ONS data there are 16,547 Gofar residents in these age brackets

**ALL 19 - 70+ Yrs  
(Standardised to  
ONS Jan 2013 Data)**

	Social Rented			Private Rented			Shared Ownership			Wholly Owned			GRAND TOTALS All Yrs			With a Care Facility %
	Flat	House	Combined	Flat	House	Combined	Flat	House	Combined	Flat	House	Combined	Flat	House	Combined	
1 - Bed	124	43	167	52	18	70	76	82	31	114	258	92	426	82	19.20%	
	6.02%	2.09%	8.12%	2.52%	0.88%	3.40%	3.69%	4.02%	1.52%	5.53%	12.56%	4.48%	20.73%	86	10.33%	
2 - Bed	152	140	291	77	52	129	170	127	119	246	356	310	836	86	10.33%	
	7.38%	6.80%	14.18%	3.76%	2.52%	6.28%	8.29%	6.18%	5.78%	11.96%	17.32%	15.10%	40.71%	30	5.01%	
3 - Bed	36	156	192	23	65	88	101	44	180	224	103	401	605	30	5.01%	
	1.76%	7.58%	9.34%	1.13%	3.15%	4.28%	4.92%	2.14%	8.78%	10.92%	5.02%	19.51%	29.46%	33	17.51%	
4 - Bed	10	32	43	3	18	21	29	11	82	93	25	133	187	33	17.51%	
	0.50%	1.58%	2.08%	0.15%	0.89%	1.04%	1.43%	0.56%	3.99%	4.55%	1.21%	6.46%	9.10%	231	11.26%	
Totals	322	371	692	155	153	308	377	265	412	677	742	936	2,054			
	15.67%	18.05%	33.71%	7.56%	7.44%	15.00%	18.34%	12.89%	20.06%	32.95%	36.12%	45.55%	100.00%			

Standardised to the ONS population of 16,547 Gofar residents in this age bracket

**Ownership Type**

**19 - 29 Yrs**  
**(61 respondents)**

	Social Rented			Private Rented			Shared Ownership			Wholly Owned			TOTALS for 19 - 29 Yrs			With a Care Facility %
	Flat	House	Combined	Flat	House	Combined	Flat	House	Combined	Flat	House	Combined	Flat	House	Combined	
1 - Bed	16	8	24	16	8	24	9	21	7	28	53	23	85	8	9.41%	
	4.47%	2.23%	6.70%	4.47%	2.23%	6.70%	2.51%	5.87%	1.96%	7.82%	14.80%	6.42%	23.74%			
2 - Bed	25	18	43	18	15	33	24	29	23	52	72	56	152	8	5.26%	
	6.98%	5.03%	12.01%	5.03%	4.19%	9.22%	6.70%	8.10%	6.42%	14.53%	20.11%	15.64%	42.46%			
3 - Bed	7	19	26	6	15	21	12	10	33	43	23	67	102	5	4.90%	
	1.96%	5.31%	7.26%	1.68%	4.19%	5.87%	3.35%	2.79%	9.22%	12.01%	6.42%	18.72%	28.49%			
4 - Bed	1	4	5	0	1	1	2	1	10	11	2	15	19	5	26.32%	
	0.28%	1.12%	1.40%	0.00%	0.28%	0.28%	0.56%	0.28%	2.79%	3.07%	0.56%	4.19%	5.31%			
Totals	49	49	98	40	39	79	47	61	73	134	150	161	358	26	7.26%	
	13.69%	13.69%	27.37%	11.17%	10.89%	22.07%	13.13%	17.04%	20.39%	37.43%	41.90%	44.97%	100.00%			

**NB based on ONS data there are 2,310 Gofar residents in this age bracket**  
**(added 19 year olds pro-rata to Age 20 - 24)**

**30 - 39 Yrs**  
**(331 respondents)**

	Social Rented			Private Rented			Shared Ownership			Wholly Owned			TOTALS for 30 - 39 Yrs			With a Care Facility %
	Flat	House	Combined	Flat	House	Combined	Flat	House	Combined	Flat	House	Combined	Flat	House	Combined	
1 - Bed	54	20	74	28	9	37	54	55	23	78	137	52	243	45	18.52%	
	3.30%	1.22%	4.52%	1.71%	0.55%	2.26%	3.30%	3.36%	1.41%	4.76%	8.37%	3.18%	14.84%			
2 - Bed	84	69	153	59	35	94	195	106	102	208	249	206	650	47	7.23%	
	5.13%	4.22%	9.35%	3.60%	2.14%	5.74%	11.91%	6.48%	6.23%	12.71%	15.21%	12.58%	39.71%			
3 - Bed	27	99	126	21	53	74	88	48	186	234	96	338	522	21	4.02%	
	1.65%	6.05%	7.70%	1.28%	3.24%	4.52%	5.38%	2.93%	11.36%	14.29%	5.86%	20.65%	31.89%			
4 - Bed	8	30	38	2	26	28	29	19	108	127	29	164	222	31	13.96%	
	0.49%	1.83%	2.32%	0.12%	1.59%	1.71%	1.77%	1.16%	6.60%	7.76%	1.77%	10.02%	13.56%			
Totals	173	218	391	110	123	233	366	228	419	647	511	760	1637	144	8.80%	
	10.57%	13.32%	23.89%	6.72%	7.51%	14.23%	22.36%	13.93%	25.60%	39.52%	31.22%	46.43%	100.00%			

**NB based on ONS data there are 3,428 Gofar residents in this age bracket**  
**(The ONS data covers 30 - 44, so I have assigned a third of it to 40 - 49 yrs)**

40 - 49 Yrs

(380 respondents)

Ownership Type

	Social Rented			Private Rented			Shared Ownership			Wholly Owned			TOTALS for 40 - 49 Yrs			With a Care Facility %
	Flat	House	Combined	Flat	House	Combined	Flat	House	Combined	Flat	House	Combined	Flat	House	Combined	
1 - Bed	91	27	118	44	15	59	67	71	32	103	206	74	347	62	17.87%	
	5.30%	1.57%	6.87%	2.56%	0.87%	3.44%	3.90%	4.14%	1.85%	6.00%	12.00%	4.31%	20.21%			
2 - Bed	105	95	200	59	39	98	125	105	92	197	269	226	620	66	10.65%	
	6.12%	5.53%	11.65%	3.44%	2.27%	5.71%	7.28%	6.12%	5.36%	11.47%	15.67%	13.16%	36.11%			
3 - Bed	16	129	145	20	59	79	106	42	162	204	78	350	534	24	4.49%	
	0.93%	7.51%	8.44%	1.16%	3.44%	4.60%	6.17%	2.45%	9.44%	11.88%	4.54%	20.38%	31.10%			
4 - Bed	14	38	52	4	20	24	31	14	95	109	32	153	216	23	10.65%	
	0.82%	2.21%	3.03%	0.23%	1.16%	1.40%	1.81%	0.82%	5.53%	6.35%	1.86%	8.91%	12.58%			
Totals	226	289	515	127	133	260	329	232	381	613	585	803	1717	175	10.19%	
	13.16%	16.83%	29.99%	7.40%	7.75%	15.14%	19.16%	13.51%	22.19%	35.70%	34.07%	46.77%	100.00%			

NB based on ONS data there are 3,100 GoFar residents in this age bracket  
 (The ONS data covers 30 - 44, so I have assigned a third of it to 40 - 49 yrs;  
 whilst the next ONS data is for 45 - 59, so I have taken a thirds of it)

50 - 59 Yrs

(356 respondents)

Ownership Type

	Social Rented			Private Rented			Shared Ownership			Wholly Owned			TOTALS for 50 - 59 Yrs			With a Care Facility %
	Flat	House	Combined	Flat	House	Combined	Flat	House	Combined	Flat	House	Combined	Flat	House	Combined	
1 - Bed	128	43	171	40	15	55	96	80	31	111	248	89	433	84	19.40%	
	6.99%	2.35%	9.33%	2.18%	0.82%	3.00%	5.24%	4.37%	1.69%	6.06%	13.54%	4.86%	23.64%			
2 - Bed	161	145	306	67	41	108	148	106	104	210	334	290	772	92	11.92%	
	8.79%	7.91%	16.70%	3.66%	2.24%	5.90%	8.08%	5.79%	5.68%	11.46%	18.23%	15.83%	42.14%			
3 - Bed	38	140	178	15	41	56	85	25	125	150	78	306	469	31	6.61%	
	2.07%	7.64%	9.72%	0.82%	2.24%	3.06%	4.64%	1.36%	6.82%	8.19%	4.26%	16.70%	25.60%			
4 - Bed	14	28	42	5	14	19	33	8	56	64	27	98	158	26	16.46%	
	0.76%	1.53%	2.29%	0.27%	0.76%	1.04%	1.80%	0.44%	3.06%	3.49%	1.47%	5.35%	8.62%			
Totals	341	356	697	127	111	238	362	219	316	535	687	783	1832	233	12.72%	
	18.61%	19.43%	38.05%	6.93%	6.06%	12.99%	19.76%	11.95%	17.25%	29.20%	37.50%	42.74%	100.00%			

NB based on ONS data there are 2,771 GoFar residents in this age bracket  
 (ONS data covers 45 - 59, so I have taken two-thirds of it)

**60 - 69 Yrs**

**(428 respondents)**

	Ownership Type												With a Care		
	Social Rented			Private Rented			Shared Ownership			Wholly Owned			TOTALS for 60 - 69 Yrs		Facility %
	Flat	House	Combined	Flat	House	Combined	Flat	House	Combined	Flat	House	Combined	Facility %		
1 - Bed	177	63	240	56	15	71	98	83	33	116	316	111	525	121	23.05%
	7.82%	2.78%	10.61%	2.47%	0.66%	3.14%	4.33%	3.67%	1.46%	5.13%	13.96%	4.90%	23.20%	118	12.27%
2 - Bed	191	206	397	80	51	131	189	118	127	245	389	384	962	24	3.80%
	8.44%	9.10%	17.54%	3.54%	2.25%	5.79%	8.35%	5.21%	5.61%	10.83%	17.19%	16.97%	42.51%		
3 - Bed	37	191	228	16	71	87	107	37	172	209	90	434	631	35	24.14%
	1.63%	8.44%	10.08%	0.71%	3.14%	3.84%	4.73%	1.63%	7.60%	9.24%	3.98%	19.18%	27.88%		
4 - Bed	5	26	31	1	18	19	27	5	63	68	11	107	145	298	13.17%
	0.22%	1.15%	1.37%	0.04%	0.80%	0.84%	1.19%	0.22%	2.78%	3.00%	0.49%	4.73%	6.41%		
Totals	410	486	896	153	155	308	421	243	395	638	806	1036	2263		
	18.12%	21.48%	39.59%	6.76%	6.85%	13.61%	18.60%	10.74%	17.45%	28.19%	35.62%	45.78%	100.00%		

NB based on ONS data there are 2,204 Gofar residents in this age bracket

(The ONS data covers 60 - 64, and 65 - 74 from which I have taken half the figure)

**70+ Yrs**

**(498 respondents)**

	Ownership Type												With a Care		
	Social Rented			Private Rented			Shared Ownership			Wholly Owned			TOTALS for 70+ Yrs		Facility %
	Flat	House	Combined	Flat	House	Combined	Flat	House	Combined	Flat	House	Combined	Facility %		
1 - Bed	194	60	254	47	8	55	60	65	16	81	306	84	450	121	26.89%
	9.16%	2.83%	11.99%	2.22%	0.38%	2.60%	2.83%	3.07%	0.76%	3.82%	14.44%	3.96%	21.24%	134	14.77%
2 - Bed	205	212	417	75	50	125	136	115	114	229	395	376	907	42	6.49%
	9.67%	10.00%	19.68%	3.54%	2.36%	5.90%	6.42%	5.43%	5.38%	10.81%	18.64%	17.74%	42.80%	42	6.49%
3 - Bed	52	227	279	23	59	82	100	30	156	186	105	442	647	40	34.78%
	2.45%	10.71%	13.17%	1.09%	2.78%	3.87%	4.72%	1.42%	7.36%	8.78%	4.96%	20.86%	30.53%		
4 - Bed	7	28	35	4	9	13	24	3	40	43	14	77	115	40	34.78%
	0.33%	1.32%	1.65%	0.19%	0.42%	0.61%	1.13%	0.14%	1.89%	2.03%	0.66%	3.63%	5.43%	337	15.90%
Totals	458	527	985	149	126	275	320	213	326	539	820	979	2119		
	21.61%	24.87%	46.48%	7.03%	5.95%	12.98%	15.10%	10.05%	15.38%	25.44%	38.70%	46.20%	100.00%		

NB based on ONS data there are 2,734 Gofar residents in this age bracket

(The ONS data covers 65 - 74 from which I have taken half the figure, and then all over 75)

Original URL: <http://www.neighbourhood.statistics.gov.uk/dissemination/LeadTableView.do?a=7&b=11123772&c=godalming&d=16&e=13&f=30636&q=6470708&i=1001x1003x1004x1005&l=2474&o=362&m=0&r=1&s=1449682735266&enc=1>

## Age Structure, 2011 (KS102EW) Period: Mar11

Last Updated: 30 January 2013  
Source: Office for National Statistics

### Area: Godalming (Parish)

Variable	Measure	Godalming	Waverley (Non-Metropolitan District)	South East	England
All Usual Residents (Persons) <sup>1</sup>	Count	21,804 <sup>2</sup>	121,572	8,634,750	53,012,456
Age 0 to 4 (Persons) <sup>1</sup>	Count	1,579 <sup>2</sup>	7,341	534,235	3,318,449
Age 0 to 4 (Persons) <sup>1</sup>	%	~	6.0	6.2	6.3
Age 5 to 7 (Persons) <sup>1</sup>	Count	743 <sup>2</sup>	4,548	299,327	1,827,610
Age 5 to 7 (Persons) <sup>1</sup>	%	~	3.7	3.5	3.4
Age 8 to 9 (Persons) <sup>1</sup>	Count	426 <sup>2</sup>	2,787	188,731	1,145,022
Age 8 to 9 (Persons) <sup>1</sup>	%	~	2.3	2.2	2.2
Age 10 to 14 (Persons) <sup>1</sup>	Count	1,222 <sup>2</sup>	7,727	512,875	3,080,929
Age 10 to 14 (Persons) <sup>1</sup>	%	~	6.4	5.9	5.8
Age 15 (Persons) <sup>1</sup>	Count	311 <sup>2</sup>	1,691	106,916	650,826
Age 15 (Persons) <sup>1</sup>	%	~	1.4	1.2	1.2
Age 16 to 17 (Persons) <sup>1</sup>	Count	720 <sup>2</sup>	3,523	217,612	1,314,124
Age 16 to 17 (Persons) <sup>1</sup>	%	~	2.9	2.5	2.5
Age 18 to 19 (Persons) <sup>1</sup>	Count	434 <sup>2</sup>	2,696	217,156	1,375,315
Age 18 to 19 (Persons) <sup>1</sup>	%	~	2.2	2.5	2.6
Age 20 to 24 (Persons) <sup>1</sup>	Count	889 <sup>2</sup>	5,101	534,287	3,595,321
Age 20 to 24 (Persons) <sup>1</sup>	%	~	4.2	6.2	6.8
Age 25 to 29 (Persons) <sup>1</sup>	Count	1,243 <sup>2</sup>	5,248	528,057	3,650,881
Age 25 to 29 (Persons) <sup>1</sup>	%	~	4.3	6.1	6.9
Age 30 to 44 (Persons) <sup>1</sup>	Count	5,142 <sup>2</sup>	24,065	1,761,278	10,944,271
Age 30 to 44 (Persons) <sup>1</sup>	%	~	19.8	20.4	20.6
Age 45 to 59 (Persons) <sup>1</sup>	Count	4,157 <sup>2</sup>	24,987	1,716,857	10,276,902
Age 45 to 59 (Persons) <sup>1</sup>	%	~	20.6	19.9	19.4
Age 60 to 64 (Persons) <sup>1</sup>	Count	1,253 <sup>2</sup>	8,036	535,399	3,172,277
Age 60 to 64 (Persons) <sup>1</sup>	%	~	6.6	6.2	6.0
Age 65 to 74 (Persons) <sup>1</sup>	Count	1,901 <sup>2</sup>	11,961	763,695	4,552,283
Age 65 to 74 (Persons) <sup>1</sup>	%	~	9.8	8.8	8.6
Age 75 to 84 (Persons) <sup>1</sup>	Count	1,230 <sup>2</sup>	7,990	501,118	2,928,118
Age 75 to 84 (Persons) <sup>1</sup>	%	~	6.6	5.8	5.5
Age 85 to 89 (Persons) <sup>1</sup>	Count	367 <sup>2</sup>	2,368	139,576	776,311
Age 85 to 89 (Persons) <sup>1</sup>	%	~	1.9	1.6	1.5
Age 90 and Over (Persons) <sup>1</sup>	Count	187 <sup>2</sup>	1,503	77,631	403,817
Age 90 and Over (Persons) <sup>1</sup>	%	~	1.2	0.9	0.8
Mean Age (Persons) <sup>1</sup>	y	~	41.5	40.0	39.3
Median Age (Persons) <sup>1</sup>	y	~	42	40	39

### Notes

<sup>1</sup> National Statistics

<sup>2</sup> Value derived by aggregating data supplied using the Neighbourhood Statistics Geography Hierarchy

This material is Crown Copyright. You may re-use this information (not including logos) free of charge in any format or medium, under the terms of the Open Government Licence. To view this licence, visit [www.nationalarchives.gov.uk/doc/open-government-licence](http://www.nationalarchives.gov.uk/doc/open-government-licence) Information Policy Team, The National Archives, Kew, London TW9 4DU, or email: [psi@nationalarchives.gsi.gov.uk](mailto:psi@nationalarchives.gsi.gov.uk). When reproducing this material, the source should be acknowledged.

Gofar Questionnaire

Transformation of ONS Stats into Gofar's Age Groupings

<u>ONS</u>	<u>Census Population</u>	<u>Assignment</u>		<u>Gofar Age Groups</u>
Age 20 - 24	889	add 1 year	178	Age 19 - 29
Age 25 - 29	1,243		889	
			1,243	2,310
Age 30 - 44	5,142	10 / 15 years		Age 30 - 39
		5 / 15 years	1,714	Age 40 - 49
Age 45 - 59	4,157	5 / 15 years	1,386	
		10 / 15 years		Age 50 - 59
				2,771
Age 60 - 64	1,253	5 / 10 years	1,253	Age 60 - 69
		5 / 10 years	951	
Age 65 - 74	1,901	5 / 10 years	950	Age 70+
Ages 75 to 90+	1,784		1,784	
				2,734
				TOTAL 16,547